

SKS
VALVES

valve
cim



Fit & Forget...
High Performance Valves

cimberio • Made in Europe

- 2 Production Plants
- 5 Distribution Centres
- 215 Workers
- 32,000 M² of House Facilities
- 1,00,000 Items a Day
- 22,000,000 Items a Year
- 1 Brand- **cim**
- M/s. CAV.UFF. GIACOMO CIMBERIO S.P.A.ITALY- is an EN 29000/ISO 9000 Certified Company.
- The "CIM" Ball Valve are approved by various international authorities, such as the American, Australian, British, Calor, Canadian & the Swiss Gas Associations, the German Gas Institute and Underwriters Laboratories Inc. (UL Listed), etc.
- The Valve for Gas Application are BG Technology certified and also Approved to the latest EN 331:1998 Standard.
- The Cimberio, State-of-the art, Fully Automated Plant have production capacity of 1,00,000 finished valves daily.

OUR HISTORY IS A GUARANTEE OF OUR COMMITMENT A GUARANTEE THAT HAS NO LIMIT IN TIME.



CIM Red 5 Ball Valve PN25



"CIM Red 5" ball valve, an EN 29000-ISO 9000 product. Can be used for domestic & industrial plumbing, heating & pneumatic systems, oil & petrol services etc.

Body : Forged brass. **Ball :** Forged brass **Hard Chrome Plated** mirror smooth finish. **Seat :** PURE P.T.F.E **Conical Arc Cut.** **STEAM SEALS :** Double "O" Rings of H-NBR (Hydro Generated Nitrile Rubber) **Nut :** Nyloc self-locking. **ENDS :** BSP female.

Pressure Rating : Fluids 40Kg.
Temperature Rating : Fluids -20°C to +140°C.
Size : 1/2" to 2"

CIM 14 M Ball Valve



"CIM 14M" ball valve, an EN 29000-ISO 9000 product. Can be used for domestic & industrial plumbing, heating & pneumatic systems, oil & petrol services etc.

Body : Forged brass. **Ball :** Forged brass **Hard Chrome Plated** mirror smooth finish. **Seat :** Pure P.T.F.E. **Conical Arc Cut** **STEM SEALS :** Pure P.T.F.E. **Nut :** Nyloc self-locking. **ENDS :** BSP female.

Pressure Rating : 58Kg.
Temperature Rating : -20°C to +150°C.
Size : 2½", 3" & 4"

CIM 620 Ball Valve With Inbuilt Strainer



"CIM 620" ball valve with inbuilt S.S. 316 strainer can be used for domestic & industrial plumbing, heating & pneumatic systems, oil & petrol services etc.

Excellent product for the use in FCU's and in applications where a strainer is required in the same line as the valve, it is lockable & / or seal-able in open & closed positions to prevent tampering.

BODY: Forged brass, **BALL:** Forged brass **Hard chrome plated** mirror smooth finish, **SEAT:** Pure P.T.F.E. **conical arc cut,** **STEAM SEALS:** Pure P.T.F.E.,

STRAINER: S.S. 316, **Handle:** Duraluminium alloy, BSP female threads. **NUT :** Nyloc self-locking, **ENDS :** BSP female

Pressure Rating : Fluids 50Kg.
Temperature Rating : Fluids -20°C to +150°C.
Size : 1/2", 3/4" & 1".

CIM Red 6/1 Ball Valve with Butterfly Handle PN25



"CIM Red 6/1" ball valve, an EN 29000-ISO 9000 product. An excellent valve for Compact Applications (where there is space crunch). Rest or of the techno commercial detail is same as that of "CIM RED 5".

Size : 1/2", 3/4" & 1"

CIM 12 A Full Bore Ball Valve with Nylon Handle PN32



"CIM 12 A" This article was made in compliance with the quality management requirements of standard ISO 9001:2008. All articles are tested according to the standard EN 12266-1:2003. It can be used in a wide variety of sectors: **heating, air conditioning, water, sanitary systems,** pneumatic systems, oil pipelines, gasoline networks, saturated steam and generally with any non corrosive liquid. It is guaranteed for 5 years.

It is made of a brass alloy that complies with standard EN 12165-CW617N-M.

Pressure Rating : 58Kg.
Temperature Rating : -20°C/150°C.
Size : 1/2" - 2"

Why CIM?

Ball Valve

Our Unique Advantages

Self Locking Nyloc Nuts

All cim valves have self locking nyloc nuts. Cim does not use check nuts.



Advantage

Nut cannot get loose & fall off owing to repeat operations. Never loose the hand lever

Double 'O' Rings

Double 'O' rings of H-NBR/Viton rubber.



Advantage

Double 'O' rings mean double protection from leakage. H-nbr rubber withstands higher temperature range. Viton rubber is silicon free high grade rubber.

Arc Cut PTFE Seats

PTFE ball seats are cut to precisely match the ball profile.



Advantage

Maximum ball & seat contact. Long operating life. No leakage.

Expansion Clearance

Clearance space between stem and ball slot to allow for expansion due to high outside temperature and also because stem being manufactured out of rod and ball being forged which have different co-efficient of expansion.

Advantage

Valve stem will not break owing to expansion of metals.

Lead Content

Low lead content (copper - zinc - lead alloy) within 2.2% as per new Euro Norm EN 12165 - CN617 norm.

Advantage

Compliance to latest international standard for plumbing application DIN CW617 norm.

CIM 011

Mini Ball Valve



"**CIM 011**" mini ball valve can be used for domestic & industrial plumbing, heating & pneumatic systems, oil & petrol services etc.

Excellent product for compact applications like pressure gauges instrumentation lines, control panels & copper piping etc.

BODY: Forged brass single piece, **BALL:** Forged brass **Hard chrome plated** mirror smooth finish. **SEAT:** Pure P.T.F.E. **Conical arc cut, STEM SEALS:** Double

"O" rings, **Handle:** Nylon, **END:** BSP female threads.

Pressure Rating	:	Fluids 40Kg.
Temperature Rating	:	Fluids -15°C to +100°C.
Size	:	1/4", 3/8" & 1/2".

CIM 30

Spring Loaded, Uni-directional (NRV)



"**CIM 30**" check valve (NRV) can be used for domestic & industrial plumbing, heating & pneumatic systems, oil & petrol services etc. Handling water, air, vacuum etc.

Suitable for Vertical/ Horizontal or Oblique Pipelines, allows Flow in one direction only.

Main Features: The spring loaded inner valve opens and lifts under pressure of 25 mbar (0.36 psi), very low pressure drop, prevents water hammer, compact design, noiseless operation, dent-proof Hostaform soft

seating. Full flow area equal to nominal size.

Body: Forged brass, **Spring:** Conical tempered spring in S.S. 316, **Inner Valve:** Hostaform, **Valve Face:** NBR rubber, **ENDS:** Screwed BSP female x female end.

Test Pressure	:	Shell 30Kg. Seat 22Kg.
Pressure Rating	:	Fluids 20Kg. Saturated steam 7Kg
Temperature Rating	:	Fluids -10°C to +95°C.
Size	:	1/2" to 2"

CIM 32

Spring Loaded, Uni-directional (NRV)



"**CIM 32**" check valve (NRV) can be used for domestic & industrial plumbing, heating & pneumatic systems, oil & petrol services etc. Handling water, air vacuum etc.

Suitable for Vertical/Horizontal of Oblique pipelines, allows Flow in one direction only.

Main Features : Spring loaded inner valve opens & lifts under pressure of 10 mbar (0.14psi), very low pressure drop, prevents water hammer, compact design, noiseless operation, dent-proof POM (Polyoximethylene)

soft seating. Full flow area is equal to nominal size.

Compact male x female design, Requires very Little Space.

Body : Forged brass, **Spring :** Conical tempered spring in S.S. 316 **Inner valve :** POM (Polyoximethylene), **Valve Face :** NBR rubber, **ENDS :** Screwed BSP female x female end.

Test Pressure	:	Shell 25Kg. Seat 18Kg.
Pressure Rating	:	Fluids 16Kg.
Temperature Rating	:	Fluids -10°C to +95°C.
Size	:	1/2", 3/4" & 1"

CIM 45

Right Angle Ball Valve



"**CIM 45**" ball valve with male thread & knob handle, an **EN 29000 ISO 9000**, Product. **Ideally suitable for applications where there is a constraint of space.** Can be used for domestic & industrial plumbing, heating & sanitary systems etc. **Generally with every non-aggressive fluid.**

Size : 1/2"

CIM 70

Gate Valve PN16



"**CIM 70**" gate valve is **manufactured in accordance with BS 5154/B-PN 16** & can be used for domestic & industrial plumbing, heating & pneumatic systems, saturated steam, oil, petrol & high temperature hot water services etc.

Body Wedge & Bonnet : Forged brass, **Stem & Metal Parts :** Extruded brass, **Nut :** Nyloc self-locking. **Packing :** NA1030 Gr (Asbestos Free).

Suitable to max temp of 180°C Gland Packing : AF 15/MA heat resistant fibre (Asbestos Free), elastomer synthetic resin & P.T.F.E., suitable to **Max temp of**

250°C Handwheel : Registered **CIM Model** in hard duraluminium A1-S1 12 alloy shwing "ON-OFF". **ENDS :** BSP female.

Test Pressure	:	Shell 25Kg. (363psi)
	:	Seat 18Kg. (261psi)
Pressure Rating	:	Fluids 16Kg.
	:	Saturated steam 7Kg.
Temperature Rating	:	Fluids -10°C to +100°C.
	:	Saturated steam +70°C
Size	:	1/2" to 2"

CIM 23

Three Way Directional Ball Valve



"**CIM 23**" diverter 3-way valve ball valve, an **EN 29000-ISO 9000** product. Can be used for domestic & industrial plumbing, heating & pneumatic systems, oil & petrol services etc.

Main Features : T-port 3 way ball valve can be used to operate any of 2 Ports or even all the 3 ports at the same time. Bottom port remains always open. you can have one inlet & two outlets or vice-versa viz., two inlets & one outlet. Lever direction point the open port.

Body : Forged brass **Ball :** Forged brass **Hard Chrome Plated** mirror smooth finish. **Seat :** Pure P.T.F.E.

Conical Arc Cut. Stem Seals : Pure P.T.F.E. **Handle :** Duraluminium alloy. **Nut :** Nyloc self-locking. **Ends :** BPS female.

Pressure Rating	:	Fluids 20Kg.
Temperature Rating	:	Fluids -10°C to +150°C.
Size	:	1/2", 3/4" & 1"

CIM 11G / Multi-Purpose Gas Ball Valve



(Certified By BG Technology)

“**CIM 11G**” ball valve, an EN 29000-ISO 9000 product. approved in accordance to European Standards for Gas Appliances (90/306/EEC) & EN 331 : 1998.

Valve is certified by “The BG Technology”. “Calor & American Gas Associations etc.” ideally Suitable for distribution of LPG Natural & Town Gases at low pressure, Water, Saturated Steam, Compressed Air, Vacuum etc. Can be used for domestic & industrial plumbing, heating & pneumatic systems, oil & petrol services etc.

“Sealing Dimensions & Ball Diameter allows a Blind Operation Angle of.≥ 10°”

Body : Forged brass. **Ball** : Forged brass Hard Chrome Plated mirror smooth finish. **Seat** : Pure P.T.F.E. Conical Arc Cut. **Steam Seals** : Double “O” Rings of Viton Rubber (Silicon Free). **Nut** : Nyloc self-locking. **ENDS** :BPS female.

Pressure Rating	Fluids 32Kg.
	Saturated steam 9Kg Compressed air 20Kg Gas (Families 1,2 & 3) 20Kg
Temperature Rating	Fluids -20°C to +150°C. Gas -20°C to +60°C.
Size	: 1/4” to 2”

CIM 170 / Gas Ball Valve with inbuilt Hose Nipple



“**CIM 170**” ball valve, an EN 29000-ISO 9000 product. approved in accordance to European Standards for Gas Appliances (90/396/EEC) &EN331 :1998, certified by “The BG Technology”.

Ideally suitable for distribution of LPG Natural & Town Gases at low pressure. Can be used for domestic & industrial plumbing, heating & pneumatic systems, oil & petrol services etc.

Provides full grip of P.T.F.E. Seal Tape & does not allow it to slip due to knurled BSP male threads.

Body : Forged brass. **Ball** : Forged brass Hard Chrome Plated mirror smooth finish. **Seat** : Pure P.T.F.E.

Conical Arc Cut. **Stem Seals** : Double “O” Rings of Perbunan NBR-DIN 3635/1. **Nut** : Nyloc Self locking. **ENDS** :BPS knurled male.

Pressure Rating	Fluids 32Kg.
	Saturated steam 9Kg Gas (Families 1,2 & 3) 20Kg
Temperature Rating	Fluids -20°C to +150°C. Gas-20°C to +60°C
Size	: 1/2”x 8mm hose union.



CIM 17G / Gas Ball Valve



“**CIM 17G**” ball valve, an EN 29000-ISO 9000 product. is approved to the latest Euro Norms for Gas Appliances (90/396/EEC) & EN 331: 1998.

Valve is certified by “The Pascal Institute” (Pressure Equipment Directive) PED (97/23/CE) & Approved by “DIN DVGWG”. Rest of the techno commercial detail is same as that of “CIM 11G”.

Size : 1/2”, 3/4” & 1”

CIM 74A / Bronze Strainer



“**CIM 74A**” strainer is manufactured in accordance to BS 5154/B-PN 20 & can be used for filtering, heating, sanitary, pneumatic systems, water works etc.

Body : Cast Bronze (BS1400-LG2), **Bonnet** : Hot Forged Brass (EN 12165 CW617N), **Strainer** : S.S.316 Screen, **Packing** : NA 1100 (Asbestos Free) Suitable to max temp of 450°C **ENDS** : BSP female **Perforations** : 18/8 with (0.65mm dia for size 2 1/2”) & (0.75-0.80mm dia for size 3”& 4”).

Test Pressure	: Shell 30Kg. (435psi)
Pressure Rating	Fluids 20Kg.
	Saturated steam 9Kg.
Temperature Rating	Fluids -10°C to +100°C.
	Saturated steam +180°C.
Size	: 1/2” to 4”

SKS VALVES are backed by years of accumulated & all round experience, combined with the use State-of-the Art Materials & Production Resources. "SKS" - Products are carefully planned at every stage of Concept, Design & Construction. The Quality Integration from the Raw Material up to the Stage of Final Product Guarantees the "SKS" - Valve Quality.

All "SKS" - Valves OUT-PERFORM any of our competitor's owing to Better Design & Technical Features.

SKS 501

Forged Brass Ball Valve PN 25

UNIQUE FEATURES

- ✓ Forged Brass Nickel Plated Body
- ✓ Full Bore
- ✓ CW617N Grade Brass (Low Lead)
- ✓ PTFE Seats
- ✓ Self Locking Nyloc Nut
- ✓ PN25 Rating
- ✓ Screwed BSP (F) Thread

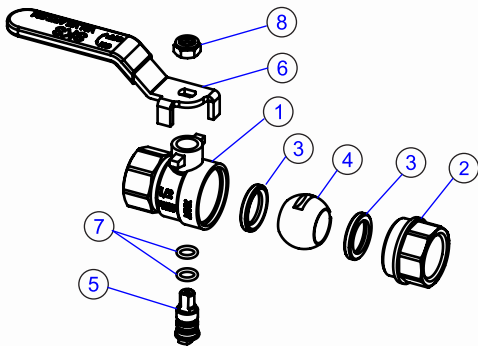

1/4" - 1/2" Assembly drawing

No.	Name	Material	Qty.
1	Body	Forged Brass CW617N	1
2	Bonnet	Forged Brass CW617N	1
3	Seat	PTFE	2
4	Ball	Forged Brass	1
5	Stem	Forged Brass	1
6	Handle	Steel Q235 with blue zinc plating with PVC RAL 5002	1
7	O-ring	EPDM with WRAS approved	2
8	Hex Nut	Steel Q235 Lock Nylon Nut	1

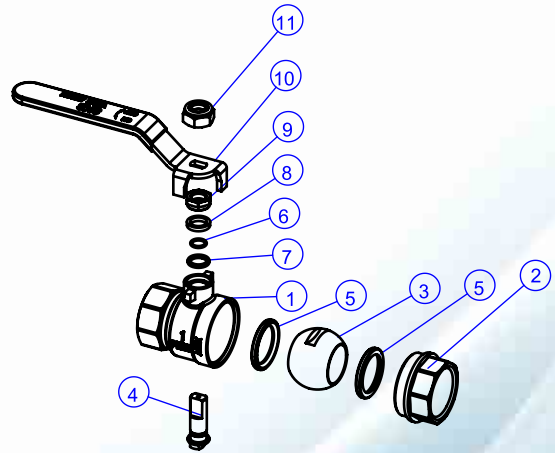

3/4" - 2" Assembly drawing

No.	Name	Material	Qty.
1	Body	Forged Brass CW617N	1
2	Bonnet	Forged Brass CW617N	1
3	Ball	Forged Brass	1
4	Stem	Forged Brass	1
5	Seat	PTFE	2
6	O-ring	EPDM with WRAS approved	2
7	Seat	PTFE	1
8	Seat	PTFE	1
9	Packing Nut	Forged Brass	1
10	Handle	Steel Q235 with blue zinc plating with PVC RAL 5002	1
11	Hex Nut	Steel Q235 Lock Nylon Nut	1

SKS 530

Forged Brass Uni-directional Check Valve



Forged brass Nickel Plated Body, Spring Loaded, Screwed BSP (F) Thread Ends

Part name	Details
Valve	Spring loaded non return valve
Body & Bonnet	Forged Brass Nickel Plated
Disc	PA6 + NBR
Spring	Stainless Steel
Temperature Rating	-10°C to + 80°C
End Connection	Screwed BSP Female Thread
Pressure Rating	PN16

Dimensions/Technical details on Request
Size : 1/2" (15mm) to 2" (50mm)

SKS 574 Y'

Forged Brass "Y" Strainer



Part name	Details
Valve	'Y' Strainer
Body & Bonnet	Forged Brass
Filter	Stainless Steel
Washer	Klingerit
Temperature Rating	-10°C to + 80°C
End Connection	Screwed BSP Female
Pressure Rating	PN16

Dimensions/Technical details on Request
Size : 1/2" (15mm) to 4" (100mm)

SKS 511

Forged Brass Mini Ball Valve



Part name	Details
Valve	Mini Ball Valve
Body	Forged Brass Nickel Plated
Ball	Forged Brass Hard Chrome Plated
Stem	Brass Rod Machine
O' Ring	NBR
Seat	PTFE
Screw	Steel with Zinc Plating
Operation	Quarter Turn
Temperature Rating	-10°C to + 110°C
End Connection	Screwed BSP
Pressure Rating	PN16

Dimensions/Technical details on Request
Size : 1/4" (06mm) to 1/2" (15mm)

SKS 534

Forged Brass Bib Cock



Part name	Details
Valve	Bib Cock
Body	Forged Brass Nickel Plated
Ball	Forged Brass Hard Chrome Plated
Stem	Brass Rod
O' Ring	NBR
Seat	PTFE
Nut	Steel with Dacromet Plated
Operation	Quarter Turn
Temperature Rating	-10°C to + 110°C
End Connection	Screwed BSP
Pressure Rating	PN16

Dimensions/Technical details on Request
Size : 1/4" (06mm) to 1/2" (15mm)

SKS 910

Preset Safety Valve



Forged brass angle type automatic (Preset at 3 Kg.) Safety Valve with diaphragm.

Part name	Details
Valve	Safety Valve
Body & Bonnet	Forged Brass angle type automatic (Preset at 3kg.)
Outlet Range	3 Bar
Max working temperature	80°C
External surface	yellow
Pressure Rating	PN16

Dimensions/Technical details on Request
 Size : 1/2" (6mm) to 3/4" (20mm) & 1" (25mm)

SKS 102

Pressure Reducing Valves (PRV) PN10



Pressure reducing valves (PRV) is best suited for controlling the outlet pressure of water in various applications such as before the appliances, sanitary / domestic & industrial plumbing services etc.

Main Features :

- Metallic brass diaphragm system for better pressure control.

SKS 102 Pressure reducing valve (nickel plated) with brass diaphragm.

Body : Forged brass, **Seal :** Stainless steel. **"O" Ring:** NBR. **Ends :** Screwed BSP female.

Max inlet Range : 10Kg.

Max operating temperature : 80°C

Max outlet range : 1 to 4Kg.

Size : 1/2" (15mm), 3/4" (20mm)

INSTALLATION OF THE SKS PRV

The SKS Pressure Reducing Valve functioning does not get affected by the gravity force & can therefore be installed in any position.

The PRV can get damaged by dirty water & therefore we advise to install a self-cleaning filter upstream before the PRV in order to protect the valve and any other mechanism (thermostatic mixers, taps, etc.).

When there is a device which produces or stores hot water or the pipes are exposed to sudden changes in temperature, an increase of outlet pressure may occur. This happens due to the increase in pressure that follows the increase in temperature. An expansion vessel between downstream & the PRV will avoid this problem. We also recommend to install a water hammer arrestor to prevent water hammer which would damage the inner parts of the PRV and other devices in the waterworks.

SKS 200

Automatic Air-Vent



"SKS" Air-Vent an EN 29000 - ISO 9000 product, can be used for domestic & industrial plumbing, heating / hot water & sanitary applications, pneumatic & condense systems.

Main Features:

The Air-Vent automatically allows the accumulated / blocked air in the pipeline networks to breathe out of the system thus removing air pockets & eventually eliminating related problems such as noise & erratic water supply etc.

Pressure Rating : 10Kg.
Temperature Rating : 110°C.
Size : 3/8" (10mm) & 1/2" (15mm).

SKS 143

Pressure Reducing Valves (PRV) PN 25



- Direct acting brass pressure reducing valve.
- PN 25.
- Brass diaphragm mechanism.
- Pressure compensation system.
- Female threading.

Tested according to rules: DIN EN 1567
 Suitable fluids: Water, compressed air
 Reduction rate : 10 : 1

MATERIALS:

Body : Brass alloy CW617N UNI EN 12165 - CB753S EN 1984
Inner parts : Brass alloy CW614N UNI EN 12164
Seat : Stainless steel AISI 303
Bar : Brass alloy CW614N UNI EN 12164
 Stainless steel AISI 303
O-rings : NBR 70sh
Flat gaskets : Fasit Italy
Plastic parts : Ultramid® A3K (BASF)

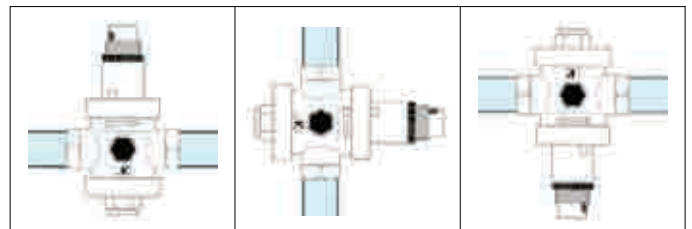

Max inlet Range : 25Kg.
Max outlet range : 0.5 to 6 Kg.
Max operating temperature : 80°C
Size : (1/2") 15mm to 6" (150mm)



SKS Butterfly Valve (PN-16 / PN-20 / PN-25) SELECTION GUIDE

Part Name	PN16	PN20	PN25
	SKS116EL (PN16) Lever Type SKS116EG (PN16) Gear Type	SKS117EL (PN20) Lever Type SKS117EG (PN20) Gear Type	SKS118EL (PN25) Lever Type SKS118EG (PN25) Gear Type
Valve	Butterfly Valve	Butterfly Valve	Butterfly Valve
Body	C.I	D.I.	D.I.
Disc	D.I. (Electroless nickel plated)	D.I. (Electroless nickel plated)	D.I. (Electroless nickel plated)
Liner	EPDM	EPDM	EPDM
Stem	ASTM A 276, GR SS410	ASTM A 276, GR SS410	ASTM A 276, GR Ss410
Bush	PTPE/ Nylon	PTPE/ Nylon	PTPE/ Nylon
O-Ring	EPDM / Nitrile	EPDM / Nitrile	EPDM / Nitrile
Notch Plate	M.S. (Powder Coating)	M.S. (Powder Coating)	M.S. (Powder Coating)
Actuator	M.S. (Powder Coating) Hand lever / D.I. Gear	M.S. (Powder Coating) Hand lever / D.I. Gear	M.S. (Powder Coating) Hand lever / D.I. Gear
Fastner	G.I.	G.I.	G.I.
Temperature	-40°C to +120°C	-40°C to +120°C	-40°C to +120°C

Part Name	PN16	PN20	PN25
	SKS116S4L (PN16) Lever Type SKS116S4G (PN16) Gear Type	SKS117S4L (PN20) Lever Type SKS117S4G (PN20) Gear Type	SKS118S4L (PN25) Lever Type SKS118S4G (PN25) Gear Type
Valve	Butterfly Valve	Butterfly Valve	Butterfly Valve
Body	C.I.	D.I.	D.I.
Disc	SS304	SS304	SS304
Liner	EPDM	EPDM	EPDM
Stem	ASTM A 276, GR SS410	ASTM A 276, GR SS410	ASTM A 276, GR SS410
Bush	PTPE/ Nylon	PTPE/ Nylon	PTPE/ Nylon
O-Ring	EPDM	EPDM	EPDM
Notch Plate	M.S. (Powder Coating)	M.S. (Powder Coating)	M.S. (Powder Coating)
Actuator	M.S. (Powder Coating) Hand lever / D.I. Gear	M.S. (Powder Coating) Hand lever / D.I. Gear	M.S. (Powder Coating) Hand lever / D.I. Gear
Fastner	G.I.	G.I.	G.I.
Temperature	-40°C to +120°C	-40°C to +120°C	-40°C to +120°C

Part Name	PN16	PN20	PN25
	SKS116S6L (PN16) Lever Type SKS116S6G (PN16) Gear Type	SKS117S6L (PN20) Lever Type SKS117S6G (PN20) Gear Type	SKS118S6L (PN25) Lever Type SKS118S6G (PN25) Gear Type
Valve	Butterfly Valve	Butterfly Valve	Butterfly Valve
Body	C.I.	D.I.	D.I.
Disc	SS316	SS316	SS316
Liner	EPDM	EPDM	EPDM
Stem	ASTM A 276, GR SS410	ASTM A 276, GR SS410	ASTM A 276, GR SS410
Bush	PTPE/ Nylon	PTPE/ Nylon	PTPE/ Nylon
O-Ring	EPDM / Nitrile	EPDM / Nitrile	EPDM / Nitrile
Notch Plate	M.S. (Powder Coating)	M.S. (Powder Coating)	M.S. (Powder Coating)
Actuator	M.S. (Powder Coating) Hand lever / D.I. Gear	M.S. (Powder Coating) Hand lever / D.I. Gear	M.S. (Powder Coating) Hand lever / D.I. Gear
Fastner	G.I.	G.I.	G.I.
Temperature	-40°C to +120°C	-40°C to +120°C	-40°C to +120°C

Size : 1 1/2" (40mm) to 24" (600mm) Dimension/ Technical detail on request

SKS116**Butterfly Valve (PN-16 / PN-20 / PN-25)****DESIGN CRITERIA & ADVANTAGE**

- Simple Mounting/Easy Automation & Retrofit Possible.
- Long Service Life with Little or Nil Maintenance.
- Anti-Blowout Spindle/Suitable for high Vacuum Conditions.
- 100% Bi-directional Tight shut off through Centric Valve Disc & Shaft Position.
- Symmetric / Streamlined Valve Disc & Profile, therefore Little Pressure Loss.
- Bushing Supported Shaft Bottom for Low Torque Requirement.
- Weather Shaft & Pressure Surge Seals Eliminates all Possible Leakages.

UNIQUE "TWIN ADVANTAGE" OF PHENOLIC BACKING

- Combination of (Integral Bonded /Replaceable Type) Rubber Seat/ Sleeve
- High Liner Strength / Stretch Resistant / Non- Collapsible & Anti-Deformation
- Nil Seat & Body Friction / Nil Corrosion of the body beneath the seat.
- No need to scrap the valve due to damaged sleeve - Easy Field Replacement.



Why SKS ?

Our Unique Advantages : SKS Butterfly Valves

Body

Powder coated smooth finish



Advantage

Long body life. High quality surface finish.

Disc Edge

Mirror smooth ground edges



Advantage

Smooth gliding function. No tearing off the rubber sleeve.

Disc

Ductile iron electroless nickel plated disc



Advantage

Does not chip off like epoxy coating.

Shaft

CS/SS304 single piece through shaft with spline design technology.



Advantage

Proper control on disc movement. Unlike 2 piece shaft, disc will not break on hammering.

Sleeve

EPDM replaceable type sleeve.



Advantage

Replaceable type phenolic backed epdm rubber sleeve to withstand -40 degree C to + 120 degree C for continuous operation.

Axial Bushes

Shaft bottom has axial bush arrangement.

Advantage

Smooth operation. Low torque requirement. Anti-jam.

SKS 310D

Dual Plate NRV



Sr. No.	Part Name	Details
1	Body	Cast Iron (Fine Graded Casting)
2	Disc	DI/S.S.
3	Stem	S.S. 410
4	Spring & Hinge Pin	SS 304 (CF 8)
5	Washer	P.T.F.E.
6	Seat Ring	E.P.D.M.
7	Gasket	NBR
8	Hex nut	A 193 B

Pressure & Temperature Rating

Nominal / Work Pressure	1.0 Mpa / 1.6 Mpa
Body Test Pressure	1.5 Mpa / 2.4 Mpa
Seat Test Pressure	1.1 Mpa / 1.8 Mpa
Temperature Rating	-15°C to + 150°C

Dimensions / Technical Detail On Request
Size : 2" (50mm) to 10" (250mm)

SKS 315

Single Plate Water Check Valve (NRV)



Application : Water / Air / Steam / Oil & Gas etc.

Distinct Advantage over Conventional Swing Check Valve (NRV):

- Stronger, Lighter & Smaller Size - about 1/8th the weight of conventional NRV.
- Silent valve - water hammer & slamming almost eliminated.
- Low pressure drop hence lower energy loss.
- Can be installed in Horizontal / Vertical lines without any special pipe support.

Sr. No.	Part Name	Details
1	Body & Disc	C.I./C.S./M.S./S.S./S.G. Iron
2	Hinge & Stop Pin	M.S./S.S. or Buyers Specification
3	Seat Seal	E.P.D.M./Nitrile/Neoprene or Metal
4	End Facing	Plain/Raised Face/Ring Joint Facing
5	Flange Rating	ASA # 150
6	Pressure Rating	ANSI 125, 150, 250, 300
7	Temperature Rating	-10°C to + 120°C

Please contact for Dimensions/Technical details.
Size : 1 1/2" (40mm) to 16" (400mm)

SKS 274 Y CI/274 Y CS

Strainer - Flanged



DESCRIPTION : SKS 274 "Y" Strainer
MOC BODY : SKS 274 CI/CS
BODY : SKS 274 CS
INTERNALS : SS (CF8 / CF8M)
SIZE : 1" to 16"

SKS 130

C.I. Balancing Valve PN16



SKS 130 The Balancing Valves is designed for double regulating, control and shut off valve.

Features

- Wide size range (Dn300)
- Operated by Hand Wheel
- Cast Iron Body
- SS Disc

Part name	Details
Valve	Balancing Valve, Flanged Ends
Body	IS : 210, FG 220 CAST IRON
Stem	ASTM A276, GR SS 410
Hand Wheel	Cast Iron
Seat Seal	EPDM
Disc	SS
Water Shell Test Pressure	24 Kg
Seat Test Pressure	17 Kg
Temperature	-10°C - +110°C Maximum

Dimension/ Technical detail on request
Size : 2" (50mm) to 12" (300mm)

SKS CI 274 PCI

POT Strainer - Flanged



DESCRIPTION : Bucket / Pot Strainer
MOC BODY : CI / MS / CS
INTERNALS : SS (CF8 / CF8M)
SIZE : 1.5" to 16"

SKS 225

SS Ball Valve

SS 304 (CF 8) Screwed

"SKS" SS 304 (CF 8) Single / Two piece design, full bore lever operated ball valve, blow out proof stem floating ball, ANSI #800, BSPT screwed female end.



Sr. No.	Part Name	Details
1	Body	S.S. 304 (CF8)
2	Cap	S.S. 304 (CF8)
3	Ball	S.S. 304 (CF8)
4	Seat	Pure P.T.F.E.
5	Stem	S.S. 304 (CF8)
6	Handle	S.S. 304 (CF8)
7	Packing	Pure P.T.F.E.
8	Seal Gasket	Pure P.T.F.E.
9	Nut	S.S. 304 (CF8)
10	Lever Sleeve	PVC
11	Pressure Rating	1000PSI
12	Temperature Rating	-20°C to 180°C

Dimensions/Technical details on Request
Size : 1/4" (6mm) to 2" (50mm)

SKS 236

SS 3 Piece Design Ball Valve

SS 316 (CF 8M) Screwed

"SKS" SS 316 (CF 8M) three piece design, full bore lever operated ball valve, blow out proof stem, floating ball, ANSI #800, BSPT screwed end.



Dimensions/Technical details on Request
Size : 1/2" (15mm) to 3" (80mm)

Sr. No.	Part Name	Details
1	Body	S.S. 316 (CF8M)
2	Cap	S.S. 316 (CF8M)
3	Ball	S.S. 316 (CF8M)
4	Seat	Pure P.T.F.E.
5	Stem	S.S. 316 (CF8M)
6	Handle	S.S. 316 (CF8M)
7	Packing	Pure P.T.F.E.
8	Seal Gasket	Pure P.T.F.E.
9	Nut	S.S. 316 (CF8M)
10	Lever Sleeve	PVC
11	Pressure Rating	1000PSI
12	Temperature Rating	-20°C to 180°C

SKS 230

CI Ball Valve



DESCRIPTION : CI Ball Valve, 3 Pc Design, Flanged Ends, to ASA#150

MOC BODY : CI (SKS 230)

INTERNALS : SS304

SIZE : 1" TO 16"

SKS 210

SS 3 Piece Design Ball Valve

CS (WCB) Screwed / Socket - Weld

"SKS" C.S. (ASTM A 216 Gr. WCB) three piece design, full bore lever operated ball valve, blow out proof stem, floating ball, ANSI #800, (BSPT Screwed/Socket weld) End.

- Manufactured to BS 5351
- Tested to BS 6755 (Part 1).
- Screwed female ends to BSP / BSPT / NPT
- Socket weld ends to ANSI B 16.11.



Dimensions/Technical details on Request
Size : 1/2" (15mm) to 2" (50mm)

Sr. No.	Part Name	Details
1	Body	ASTMA 216 Gr. WCB
2	Body Connector	ASTMA 216 Gr. WCB
3	Ball	S.S. 304(CF8)
4	Seat	Pure P.T.F.E.
5	Stem	S.S. 304 (CF8)
6	Body Seal	Pure P.T.F.E.
7	Gland Packing	Pure P.T.F.E.
8	Stem Seal	Pure P.T.F.E.
9	Studs	S.S. 304 (CF8)
10	Nuts	S.S. 304 (CF8)
11	Lever Sleeve	PVC
11	Pressure Rating	1000PSI
12	Temperature Rating	-20°C to 180°C

SKS 220, 240, 246

CS/SS Ball Valve

Flanged end

C.S. (WCB) / S.S. 304 (CF 8) / S.S. 316 (CF 8M)

three piece design, full bore ball valve, blow out proof stem, floating ball, ANSI # 150 & 300, flanged end.

Main Features :

- Manufacturing standard: BS 5351
- Testing standard : BS 5146 /6755
- Face to Face : ANSI B 16.10
- End Connections : Flanged end to ANSI B 16.5 RF / BS 10 / IS 6392. Special flanged connection available on request. Valves up to 50mm with hand levers, 65mm & above with extension handles.



Sr. No.	Part Name	Details
1	Body	ASTMA 216 Gr. WCB / ASTM A351 Gr. CF8 /CF 8M
2	Body Connector	ASTMA 216 Gr. WCB / ASTM A351 Gr. CF8 /CF 8M
3	Connector Seal	Pure P.T.F.E.
4	Ball Seat	Pure P.T.F.E.
5	Ball	ASTMA Gr. 351 CF8 /CF 8M
6	Stem	ASTMA Gr. 351 CF8 /CF 8M
7	Stem Seal & Gland Packing	Pure P.T.F.E.
8	Gland	S.S. /M.S.
9	Lever	S.S. /M.S.
10	Lever Nuts	S.S. /M.S.
11	Body Studs	S.S. /M.S.
12	Body Nuts	S.S. /M.S.
13	Lever Sleeve	PVC

Dimensions/Technical details on Request
Size : 1/2" (15mm) to 8" (200mm) / for sizes above 8" (200mm) - (on Request)



Import & Distributed by :

PIPELINE PRODUCTS
(INDIA)

(A Merger of Factory Equipments & Project Equipment)

Head Office : 3374, Hauz Qazi, Delhi- 110006

Phone : 011-43211999 (20 lines)

Fax : 011 -43211901

Email : info@pipelineproductsindia.com

Website : www.pipelineproductsindia.com

Mktg. Office : 1201, Tower-1, Pearl Omaxe

Netaji Subhash Place,

Delhi-110034